

연발리벳- 고강도 고효율 패스너

후면(접합부 뒷면)에 턱을형성하여 연속적으로(스피드 패스닝)작업되어 강한 체결력과 체결강도를 제공, 각종금속및 플라스틱의 접합에 사용

사양

사이즈 : 3.2mm - 4.8mm

재질: Aluminium Alloy, Steel

머리형상: 둥근머리 / 접시머리

특징 및 장점

높은 체결력과 내진동성

얇은모재와 연질모재에 넓은 체결부 형성

흡입성 탁월

흡채움기능 탁월

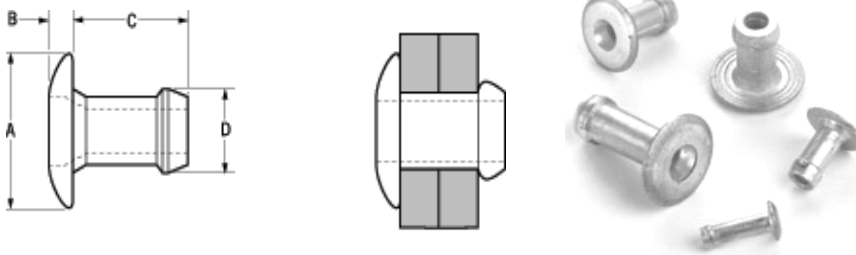

연발리벳 - 알미늄 / 둥근머리

Body	Aluminium alloy (5% magnesium) to BS 1473 5056A DIN 1725								Natural / Polished		Part Number	
size	Grip Range		Hole Size	Fasteners pod*	A		B	C	D	Shear kN		Tension kN
	min.	max.			min.	max.						
3.2	1.14	2.42	3.3	56	5.91	6.53	0.99	4.37	3.137	0.7	1.3	S1104-32040
	2.15	3.43		48				5.39				S1104-32060
	3.17	4.45		40				6.41				S1104-32080
	4.19	5.47		35				7.42				S1104-32100
	5.2	6.48		32				8.44				S1104-32120
4.0	1.57	2.93	4.0	50	7.56	8.18	0.99	4.91	3.874	1.1	1.7	S1104-40050
	2.66	3.94		42				5.92				S1104-40070
	3.68	4.96		36				6.94				S1104-40090
	4.69	5.97		32				7.95				S1104-40110
4.8	2.03	3.94	4.9	40	9.09	9.71	1.17	6.1	4.763	1.5	2.7	S1104-48070
	3.68	5.21		33				7.37				S1104-48090
	4.95	6.48		29				8.64				S1104-48110
	6.22	7.75		25				9.91				S1104-48130

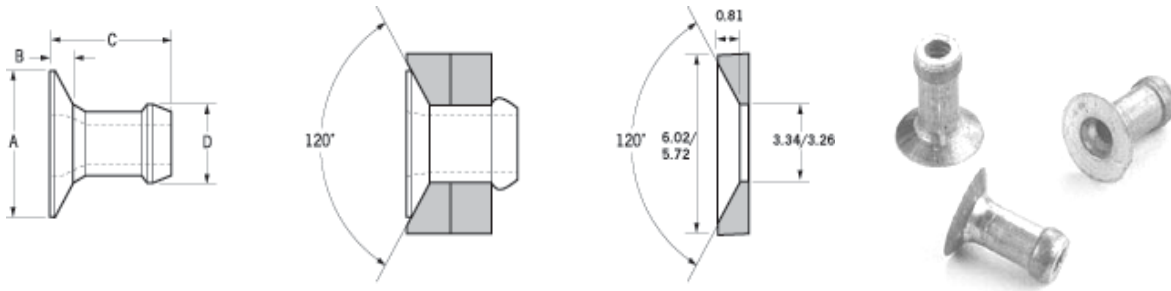

연발리벳 - 알루미늄 / 접시머리

Body		Aluminium alloy (5% magnesium) to BS 1473 5056A DIN 1725								Natural / Polished		
size	Grip Range		Hole Size	Fasteners pod*	A		B	C	D	Shear kN	Tension kN	Part Number
	min.	max.			min.	max.						
3.2	1.52	2.79	3.3	62	5.08	5.97	0.89	4.77	3.163	0.7	1.3	S1304-32060
	2.54	3.81		50				5.79				S1304-32070
	3.56	4.83		42				6.81				S1304-32080
	4.57	5.84		31				7.82				S1304-32100
	5.59	6.86		31				8.84				S1304-32110
4.0	1.57	2.93	4.0	57	6.09	6.98	1.02	5.18	3.899	1.1	1.7	S1304-40050
	2.15	3.43		52				5.69				S1304-40060
	2.66	3.94		47				6.19				S1304-40070
	3.68	4.96		40				7.21				S1304-40090
	4.69	5.97		34				8.22				S1304-40110

연발리벳 - 스틸 / 둥근머리

Body		Low Carbon Steel to BS 3111								3가크롬		
size	Grip Range		Hole Size	Fasteners pod*	A		B	C	D	Shear kN	Tension kN	Part Number
	min.	max.			min.	max.						
3.2	1.14	2.42	3.3	56	5.91	6.53	0.99	4.37	3.137	0.7	1.3	S1102-32040
	2.15	3.43		48				5.39				S1102-32060
	3.17	4.45		40				6.41				S1102-32080
	4.19	5.47		35				7.42				S1102-32100
	5.2	6.48		32				8.44				S1102-32120
4.0	1.57	2.93	4.0	50	7.56	8.18	0.99	4.91	3.874	1.1	1.7	S1102-40050
	2.66	3.94		42				5.92				S1102-40070
	3.68	4.96		36				6.94				S1102-40090
	4.69	5.97		32				7.95				S1102-40110
4.8	2.03	3.94	4.9	40	9.09	9.71	1.17	6.1	4.763	1.5	2.7	S1102-48070
	3.68	5.21		33				7.37				S1102-48090
	4.95	6.48		29				8.64				S1102-48110
	6.22	7.75		25				9.91				S1102-48130

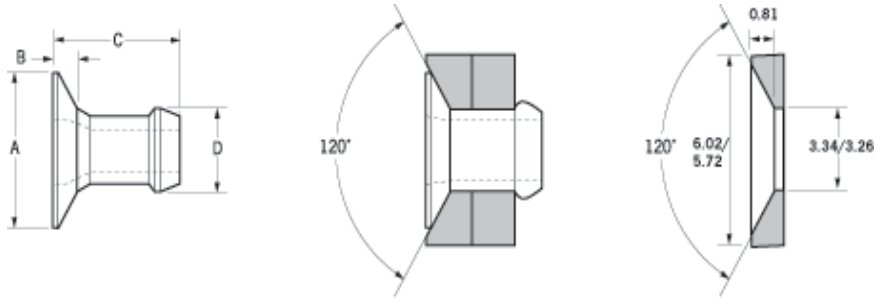

연발리벳 - 스틸 / 접시머리

Body	Low Carbon Steel to BS 3111							3가크롬				
size	Grip Range		Hole Size	Fasteners pod*	A		B	C	D	Shear kN	Tension kN	Part Number
	min.	max.			min.	max.						
3.2	1.52	2.79	3.3	62	5.08	5.97	0.89	4.77	3.163	0.7	1.3	S1302-32060
	2.54	3.81		50				5.79				S1302-32070
	3.56	4.83		42				6.81				S1302-32080
	4.57	5.84		31				7.82				S1302-32100
	5.59	6.86		31				8.84				S1302-32110
4.0	1.57	2.93	4.0	57	6.09	6.98	1.02	5.18	3.899	1.1	1.7	S1302-40050
	2.15	3.43		52				5.69				S1302-40060
	2.66	3.94		47				6.19				S1302-40070
	3.68	4.96		40				7.21				S1302-40090
	4.69	5.97		34				8.22				S1302-40110

